



Connect

Herbert Hooverplein 14 , 3000 Leuven

**Phone number:** 016 22 92 28

**E-mail:** office@connect-immo.be

## FOR SALE - CLOSED GARAGE

Volmolenlaan 28, 3000 Leuven

€ 45.000

Ref. 7033573

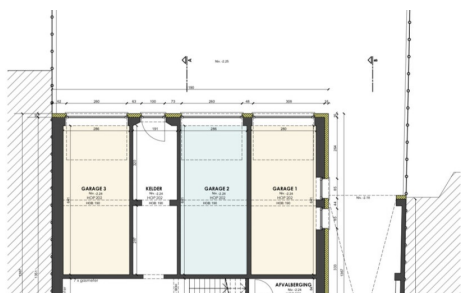

Availability: at delivery

Surf. Living: 75m<sup>2</sup>

Neighbourhood: central

# DESCRIPTION

---

## FINANCIAL

Price: € 45.000,00  
VAT applied: No  
Available: At delivery

## BUILDING

Surface: 75,00 m²  
Renovation: 2025  
State: New  
Floor: 2  
Number of floors: 2

## ENERGY

Electricity certificate: Yes, conform  
Heating type: Hot air pump

## LOCATION

Environment: Central  
School nearby: Yes  
Shops nearby: Yes  
Public transport nearby: Yes

## TECHNICS

Sewage: Yes  
Water: Yes

## PLANNING

Destination: Not disclosed  
Building permission: Not disclosed  
Parcelling permission: Not disclosed  
Right of pre-emption: No  
Asbestos inventory certificate: Yes  
Intimation: No  
G-score: B  
P-score: B  
Summons: No  
Servitude: Yes

## PARKING

Garage: Yes  
Parkings outside: No  
Parkings inside: 3